



Welcome guide



Welcome to the Walker Art Gallery

Welcome to the Walker Art Gallery
This guide will help you find your way around the gallery, if you have any questions please ask a member of staff to help you.

- The Gallery ground floor entrance is up the flight of steps shown in the building pictured above.
- You can use a ramp to enter the building which can be found to the right of the steps.
- The main entrance takes you straight to the gallery information desk via two sets of automatic glass doors.



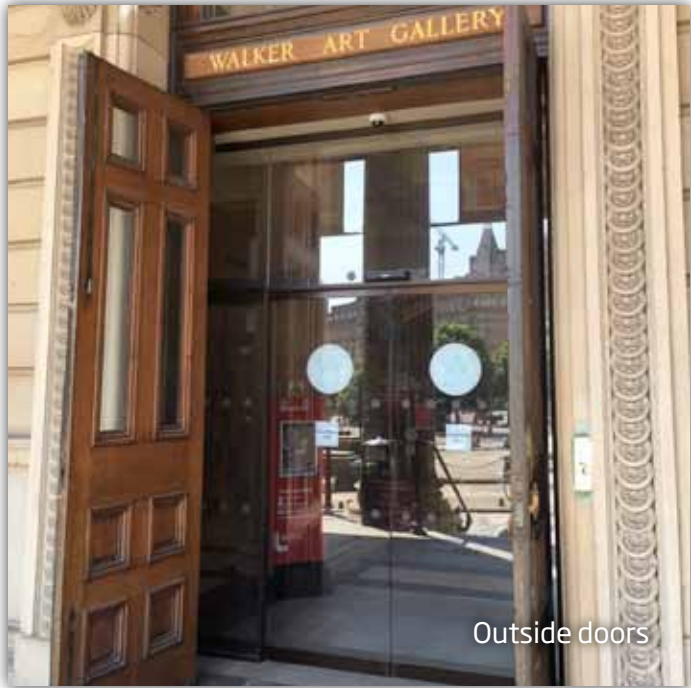

Outside doors

Getting into the Walker Art Gallery

There are two pairs of large doors.

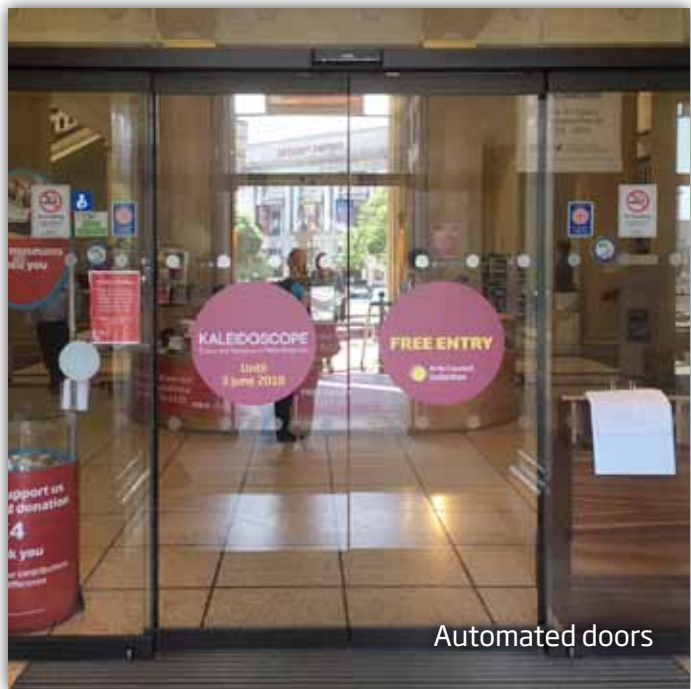

Automated doors



Member of staff

Staff

Staff wear blue shirts and name badges.

Fire alarms

If the fire alarm sounds please follow staff instructions and ask for assistance if required. Fire alarm tests are planned, if unexpected loud noises are a concern to you please call in advance to check when the next test will take place.

Floor plan

You can see the gallery is made up of lots of small rooms. You can walk a round the rooms in any order.

Ground Floor

- A** Big Art for Little Artists
- B** Sculpture Gallery
- C** Craft & Design Gallery

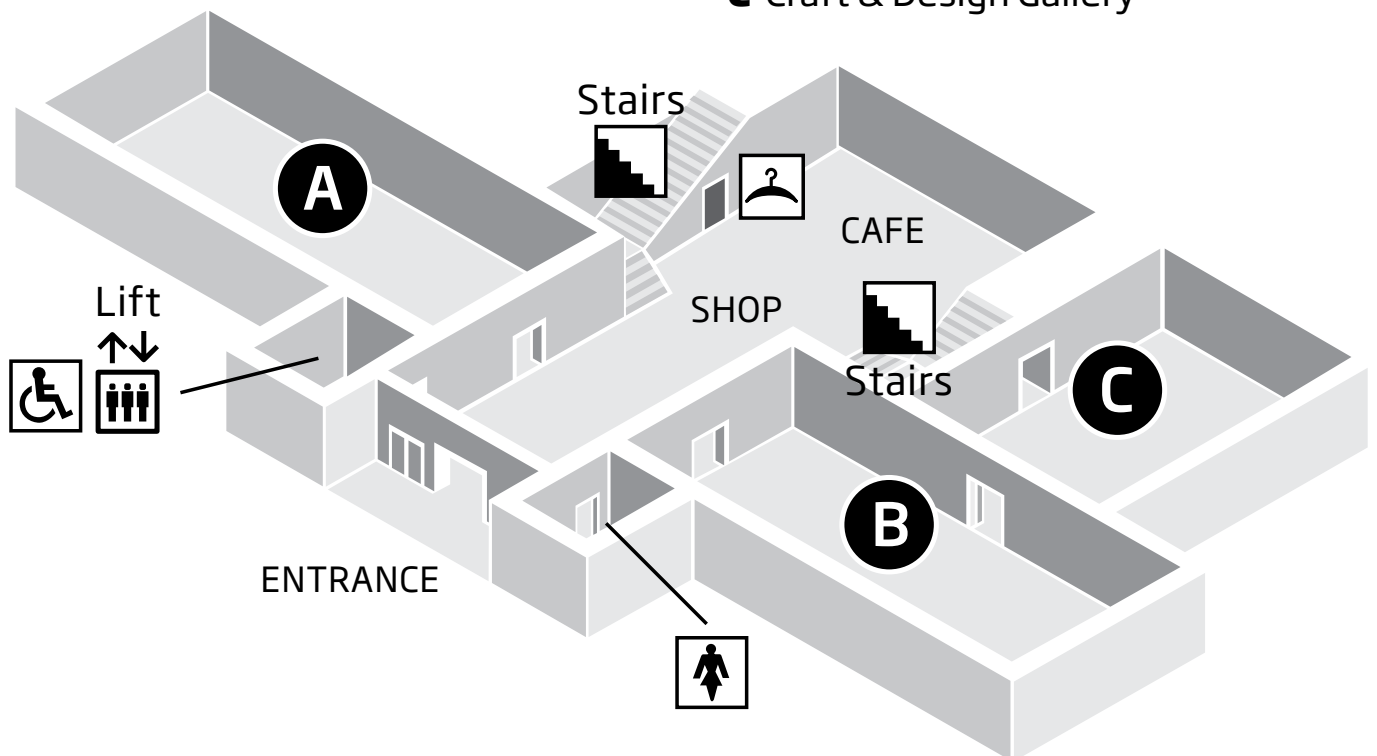



Information Desk

GROUND FLOOR

As you enter you will be faced with the Information Desk.

Staff can help with any questions:

- If you have any problems in the gallery.
- If you want to know what events are happening in the gallery.
- If you are separated from a group.
- If you have lost property in the gallery.
- If you want to collect free tickets for a talk or guided tour.
- You can let us know how your visit was in the Visitor Book.
- They will offer you a map of the gallery or an audio guide (for a charge) if you would like one.



Lift and baby changing sign



Lift doors

Lifts

- To the left of the main entrance, information desk and the Big Art for Little Artists gallery, there is a lift that you can use to travel between the Ground and First Floors.
- The lift has a mirror inside.
- The lift is signposted or the information desk staff can direct you to it.
- To access the lift from the first floor walk towards Room 12 across the landing towards the windows and the lift lobby is on the right hand side next to the baby changing facilities.

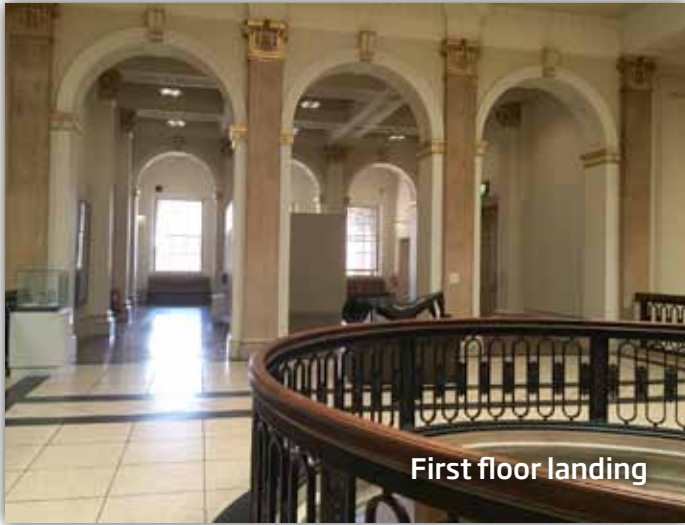

First floor landing



Toilet sign



Women and girls sign



Men and boys sign

Toilets

- There are toilets on both floors of the gallery and a baby changing room (without an adult toilet) on the first floor. On the ground floor next to the lift there is a unisex accessible toilet.
- You do not need a RADAR key to use the basement disabled toilet.
- The female toilet is on the ground floor to the left of the main entrance next to the Sculpture gallery.
- The male toilet is on the first floor to the right of Room 11.
- There isn't a Changing Places toilet at the gallery.



Cloakroom entrance



Cloakroom lockers



Locker key

Cloakroom and lockers

- To the left of the café counter you will find the cloakroom where you can leave your coats and bags in lockers if you choose
- Buggies can be left in here and tied to the wall. You will need to swap a £1 coin for a refundable token at the Information desk to operate the lockers and buggy locker which is refunded when you collect your items.
- When the children's gallery Big Art for Little Artists is busy you may be asked to move your buggy here. At quiet times there is some buggy storage within the children's gallery and you may keep your buggy with you.
- The gallery is fully accessible and buggies and wheelchairs are welcome on both floors. There are heavy glass doors between many of the upstairs rooms which wheelchair users may need assistance with.



Ground Floor galleries

The majority of the collection can be found on the First Floor. On the ground floor you will find Big Art for Little Artists (the family gallery), the Sculpture Gallery and the Craft and Design gallery, accessed by the café or sculpture gallery.

Big Art for Little Artists

- Big Art for Little Artists is a gallery for young children up to and including the age of five. It has been designed to introduce families to art with the supervision of their parents or guardians. Older children and adults are welcome too but they may find the furniture a little small.
- To enter or leave the gallery there is a push button to open the automatic doors and so young children are unable to let themselves in or out.
- There are costumes, games, puppets, sensory toys, story books and drawing materials to use everyday from 10am to 5pm.
- We host monthly quiet mornings and a range of family friendly sessions, please visit the website for the latest information: liverpoolmuseums.org.uk/walker/eventsoolmuseums.org.uk/walker/events
- We do not host messy play or painting activities in Big Art for Little Artists.



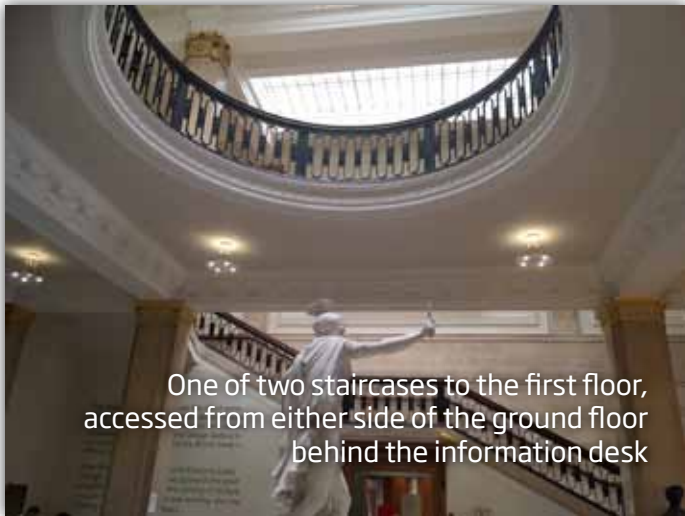

FIRST FLOOR

- The First floor is where the majority of the painting, sculpture, audio visual and furniture collection is on display.
- To see the collection in date order you can start in Room 1 at the back of the building, this is not necessary unless you want to do this. The rooms all connect and you can explore the rooms in whichever order you would like.
- You may find it useful to hire an audio guide to give you information about the collection as you walk around. These are sold at the ground floor information desk.
- When you reach the first floor via the lift or stairs you will find the first floor landing, from here you can explore the galleries.
- Interpretation can vary across these rooms, labels can be wall mounted or floor standing, if you are having difficulty finding information about an artwork please ask a member of staff to help.
- In many rooms you will find dehumidifiers which keep the environment constant to ensure the best conditions for the collections. They can be noisy.



FIRST FLOOR - Floor Plan

1 & 2 Medieval & Renaissance including Cranach, Holbein and Simone Martini

3 & 4 17th century including Poussin, Rembrandt, Rubens and Ruysdael

5 18th century including Gainsborough, Reynolds, Stubbs, Wilson and Wedgwood

6, 7, 8 & 9 19th century including Rossetti, Yeames, Turner, Millais, Liverpool Pre-Raphaelites. Room 9 includes changing displays of historic, modern and contemporary art

10 Impressionists and Post-Impressionists including Monet, Degas, Cézanne, Seurat, Sickert, Rodin and Matisse

11 British Art 1880-1950 including Spencer, Knight, Freud, Bomberg and Lowry

12, 13, 14 & 15 Modern and Contemporary art including John Moores Painting Prize past prize winners and changing exhibitions

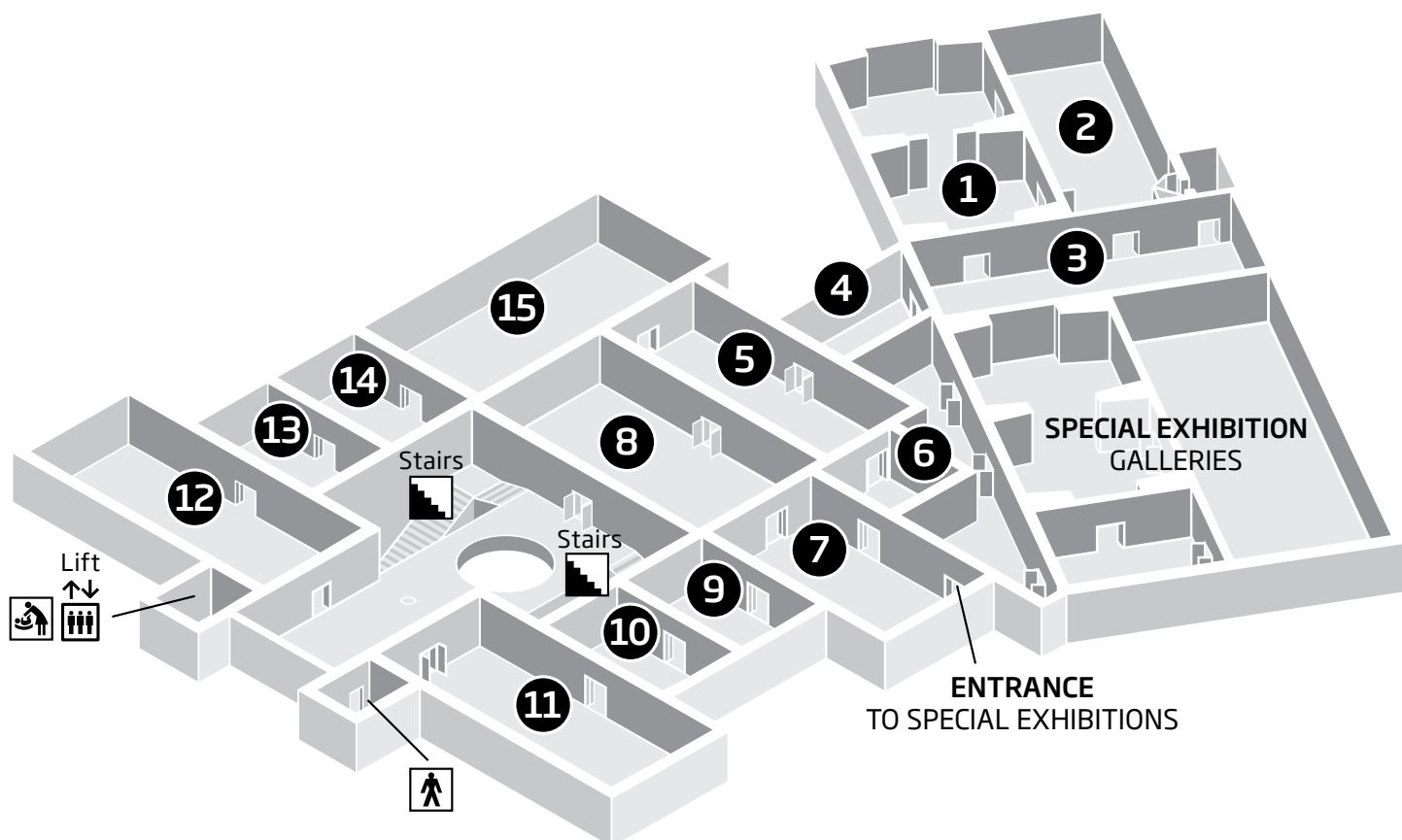



Room number

Room signage

- The rooms are numbered, or named look out for signage.



Name signage



Entrance to Room 1 from Room 3



Room 2, accessed via Room 1 or Room 3

To help you enjoy your visit we've highlighted some facts about the first floor rooms, if you have any queries about any of the rooms please ask a member of staff to help.

Rooms 1 and 2: Medieval and Renaissance art

Rooms 3 and 4: 17th century art

- These rooms are the furthest from the main entrance to the gallery and are entered via room 4. To exit you will need to retrace your steps through Room 4.
- These rooms contain the oldest artworks in our collection, many have religious themes.
- There are interactive spaces within these galleries where children can dress up and visitors can relax, draw and take inspiration from the collections.



Room 5: 18th century art collections including displays of contemporary art

- There are three doors into Room 5, the most direct route to this room is via Room 8 from the ground floor landing at the top of the stairs.
- You may also find this room via Room 15 and Room 6.



Room 6

- This small room contains some of our most famous and popular paintings by Pre-Raphaelite artists.





**Room 8:
Victorian art**

**Room 9:
19th century art**

**Room 9:
19th century art**

- Rooms 6, 7, 8 and 9 contain 19th century collections including changing displays of historic, modern and contemporary art.
- These can be the busiest rooms in the gallery and there are often school sessions or guided tours taking place. You are still able to view artworks and walk through while tours are taking place.



**Room 10:
Impressionist and
Post-Impressionist art**

- Some artworks are particularly sensitive to light and so can be viewed behind movable screens.



Room 11: British art 1880 to 1950

- This gallery has lots of interactive elements where you are encouraged to touch, draw and enjoy the collections. It is an ideal room to move on to when visitors feel too old for Big Art for Little Artist's, the children's gallery, however it is suitable for all.



'Please touch' signage



**Rooms 12, 13, 14 and 15:
Modern and Contemporary
changing displays including the
John Moores Painting Prize past
prize winners display**

- The works in these rooms are often some of the newest in our collection.
- There is a video room in Room 15 with interviews of artists who's artworks are on display.
- These rooms may be used to show temporary exhibitions, for current listings visit the website: liverpoolmuseums.org.uk/walker
- Occasionally when we are changing displays a room may be closed, if you are planning to visit to see a specific artwork we recommend you call ahead to check it is on display.

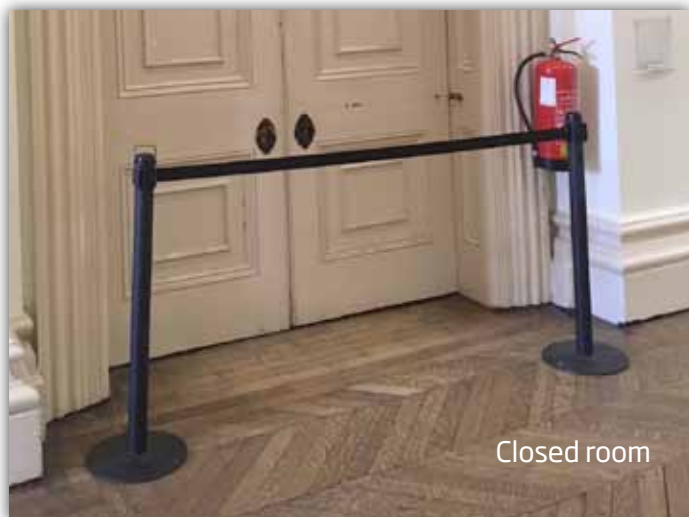



Café

- The ground floor café is open daily from 10am to 4.30pm and can be found behind the shop and information desk.
- Hot food is served between 12 - 3pm.
- Our coffee machine can be quite loud.

Open daily 10am - 5pm*

Walker Art Gallery

1

William Brown Street, L3 8EL
0151 478 4199

World Museum

2

William Brown Street, L3 8EN
0151 478 4393

Museum of Liverpool

3

Pier Head, L3 1DG
0151 478 4545

**Merseyside Maritime Museum /
International Slavery Museum /
Seized! The Border and Customs
Uncovered**

4

Royal Albert Dock Liverpool, L3 4AQ
0151 478 4499

Lady Lever Art Gallery

5

Port Sunlight Village, CH62 5EQ
0151 478 4136

Sudley House

6

Mossley Hill Road, L18 8BX
0151 478 4016

*All of our venues are open 10am-5pm every day except on 24, 25, 26 and 31 December and 1 January, when they are closed all day.

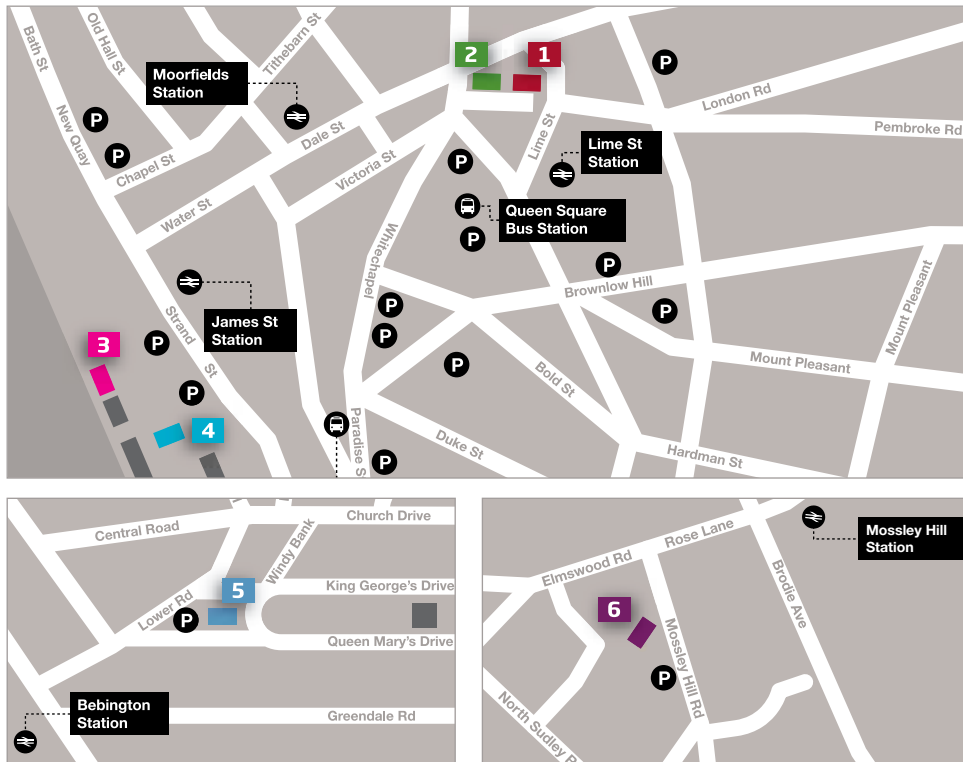

We hope that you enjoy your visit

If you have any questions, please ring the Information Desk on 0151 478 4199